

# ProAqua Shield Tanking Kit

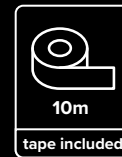

9kg

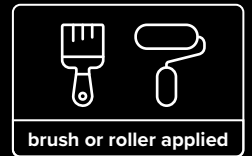
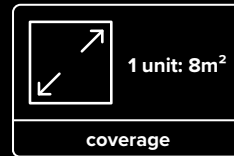

## Product Selection Guide

### Key areas of use:

- ✓ Wetrooms
- ✓ Showers
- ✓ Bathrooms
- ✓ Kitchens
- ✓ Utility rooms
- ✓ Laundry rooms
- ✓ Communal showers
- ✓ Steamrooms
- ✓ Saunas
- × Swimming pool
- ✓ Sanariums

### Suitable surfaces & substrates:

- ✓ Concrete
- ✓ Sand/cement screed
- ✓ Plywood for floor only as an overlay (15mm min)
- ✓ Tile backer boards
- ✓ Anhydrite screeds
- ✓ Firm & stable plaster
- ✓ Plasterboard
- ✓ Sand/cement render
- ✓ New brickwork
- ✓ Blockwork



# TECHNICAL DATASHEET

**UltraTile ProAqua Shield** provides waterproof protection to backgrounds in commercial environments, wetrooms, domestic bathrooms, kitchens and showers and is suitable for both walls and floors prior to tiling. It is a polymer emulsion-based product for use on internal installations only. It requires only 1 coat and can be tiled in 90 minutes without the need to prime.

**Note:** Priming is required when using **ProAqua Shield** in conjunction with **ProDeck**, please review the installation instructions.

## SURFACE PREPARATION

Ensure all areas are clean, dry, and free from dust or any other contaminating barriers. Remove any flaking or peeling layers. Background surfaces must be free from movement.

**Skim Plaster:** Ensure the plastered surface is fully cured and dust free, 14-28 days depending on temperature (with >0.5% moisture) prior to application.

**Plaster Board:** Ensure the boards are firmly fixed in place, securing any areas of deflection.

**Concrete/anhydrite type floors:** Ensure the surface is fully cured and dust free with readings less than 75% humidity. All surface laitance must be removed prior to application.

**Note:** Moisture sensitive backgrounds should be protected from moisture ingress from behind.

## APPLICATION

**UltraTile ProAqua Shield** should be applied using a brush or short pile roller to give a continuous thin layer of product at least 0.8mm thick. See application method. Drying time will be extended depending on thickness applied, porosity of background and temperature if less than 20°C.

## APPLICATION METHOD

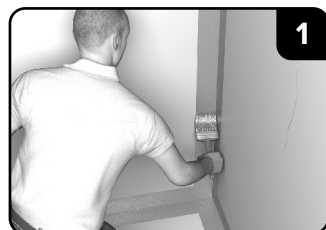

1 Apply coating to the junctions between wall to floor and wall to wall corners using a paint brush at coverage 1.1kg/sqm.

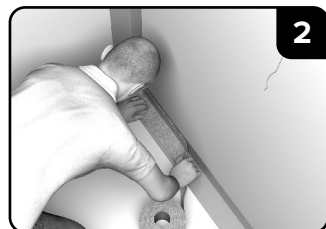

2 Bed a strip of membrane tapetape into the coating while still wet to strengthen and reinforce the junction points (adjoining boards). Tape can also be used to reinforce cracks, pipe entries and screw fixings.

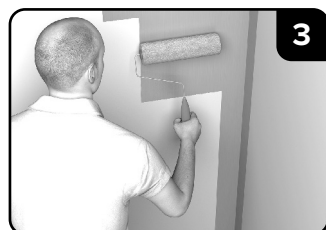

3 When dry (after 30 minutes), apply one uniform coat over the complete wall and floor area including reinforced areas in a continuous layer at a coverage of 1.1kg/sqm using a paint brush or roller as previous. Allow 90 minutes drying time before commencing tiling.

## TILING

Wall tiles should be fixed using UltraTile C2, S1 or S2 cement-based tile adhesive.

Floor tiles should be fixed using UltraTile C2, S1 or S2 cement-based tile adhesive.

**Note:** The use of dispersion adhesives may significantly extend drying times/ incomplete drying of the dispersion adhesive, depending on the tile type used.

## CLEANING

Tools should be thoroughly cleaned with water to remove excess material immediately after use.

## TECHNICAL DATA

Unit Size:	9kg Buckets (includes flexible waterproof coating and 10m membrane tape)
Colours:	Blue
Foot Traffic/Tiling*	90 minutes
Coverage:	1.1kg per m <sup>2</sup> (coverage essential to ensure protection), 8m <sup>2</sup> per unit.
Drying Time*:	90 minutes
Application Temperatures:	5°C to 30°C

\*Depending on temperatures, substrate, porosity of substrate and tile and site conditions.

## POINTS OF NOTE

The drying period for **UltraTile ProAqua Shield** will be affected by extremes in temperature. High temperature site conditions will increase the speed of drying. Low temperatures will reduce the speed of drying. It is therefore good practice to consider site conditions and storage of materials as essential factors in planning tanking installations. UltraTile would always advise that fitting and tiling installers follow the guidelines for installations and tiling as laid down in BS EN 5385. It is essential that expansion joints are built into the design of the tiling installation in order to prevent tension build up. This is a common occurrence which can result in tiles de-bonding. In flooring situations there needs to be sufficient fall to ensure the water will drain freely from the floor surface.

## STORAGE

This product must be stored in unopened buckets, in a frost free environment out of direct sunlight. Ideal storage temperatures are between 5°C and 30°C.

## SHELF LIFE

Under the above storage conditions this product has a shelf life of 12 months.

## HEALTH & SAFETY

Please ensure that appropriate PPE is used when preparing, mixing, and applying products. Always wash hands before consuming food and make sure that materials are kept safely out of reach of children and animals. Please dispose of packaging and waste appropriately. A full Safety Data Sheet relating to this product is available from [ultratileadhesives.co.uk](http://ultratileadhesives.co.uk).

## QUALITY ASSURANCE

All products are manufactured in a plant whose quality management system is certified / registered as being in conformity with BS EN ISO 9001, ISO 14001, and ISO 45001. UltraTile products are guaranteed against defective materials and manufacture and will be replaced, or money refunded if the goods do not comply with our promotional literature. We cannot however accept responsibility arising from the application or use of our products because we have no direct or continuous control over where and how our products are used. All UltraTile products are sold subject to our terms and conditions of sales, copies of which may be obtained upon request.